

# Standard Twin

D5

83 Wuhu St,  
Hung Hom,  
Kowloon

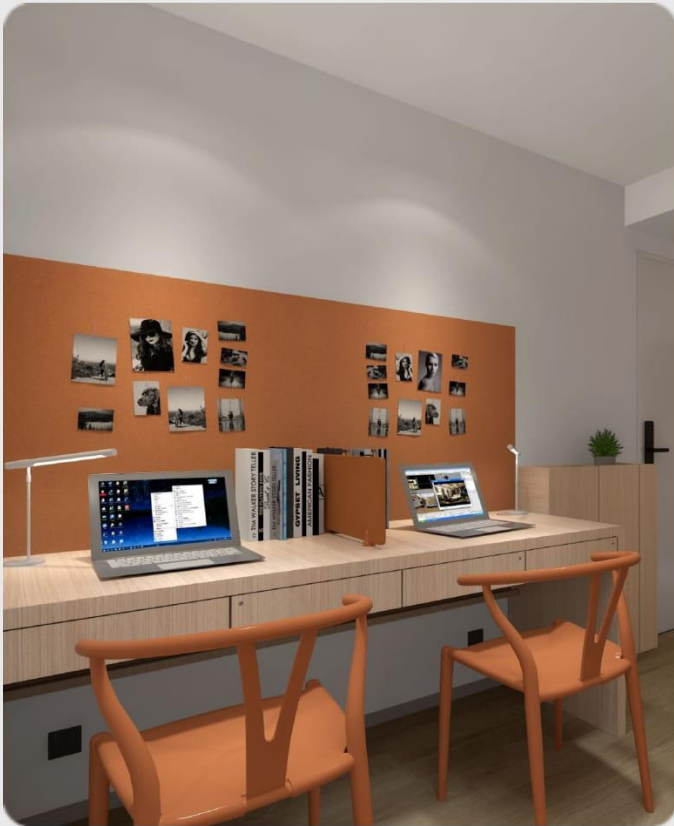

**HKD 7,000 +**  
per person per month  
12-month contract

A stylish and homey accommodation built for two with an ensuite bathroom and an area of around 170sqft. High-speed WiFi and a dedicated study desk ensures productivity, while ample storage can help you keep tidy and organised. Keycard access and air-conditioning allows you to take control of the room.



Largest student community of around 600 students



5 min walk to Ho Man Tin and Whampoa MTR

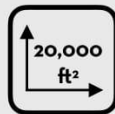

20,000 ft<sup>2</sup> of communal space



15 min walk to PolyU and 20 min walk to HKMU



Newly renovated with ergonomic design and high-quality furniture



24/7 security guard and CCTV in public areas



One-of-a-kind student-only accommodation in Hong Kong



Dedicated team to enhance the community and foster collaboration

# Room Layout

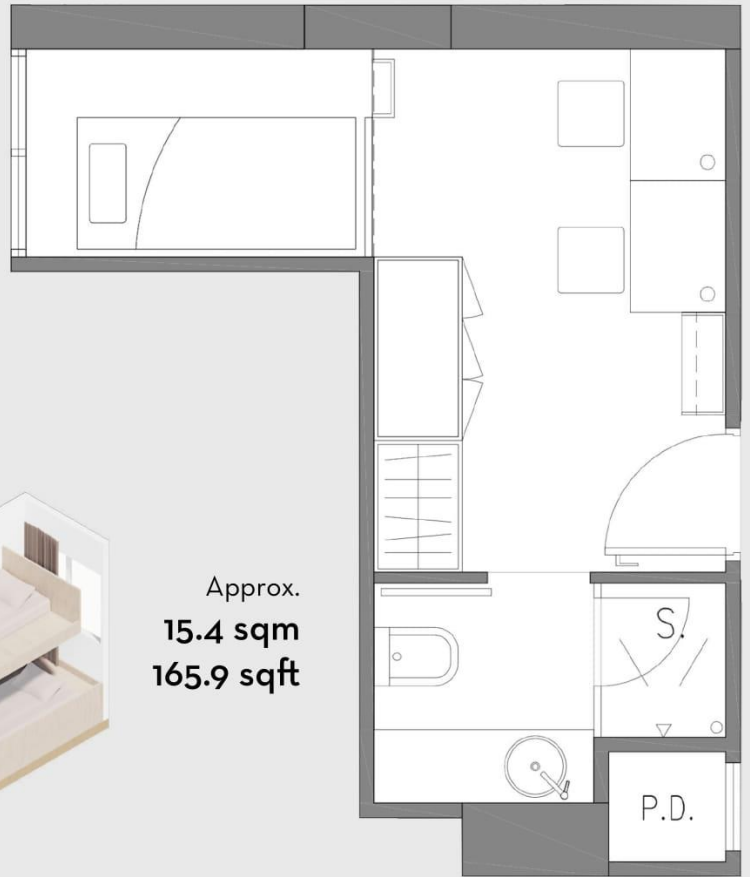

Approx.  
**15.4 sqm**  
**165.9 sqft**

## Room Amenities



High-speed WiFi



Cupboards and  
Storage



Ensuite  
Bathroom



Keycard Access



Desk and Chair



Air Conditioning



Unrestricted  
Access to  
Common Areas



Access to Shared  
Kitchen / Pantry

## Contact Us

Telephone: 5442 6939

WhatsApp: 5442 6939

WeChat: ydotxinfo

Email: [leasing.y83@ydotx.com](mailto:leasing.y83@ydotx.com)

Visit our website at

[www.ydotx.com](http://www.ydotx.com)

